

THE ROOM-TO-ROOM AIRBORNE SOUND INSULATION ACCORDING TO ISO 140-9:1985

principal: Ecophon (S)

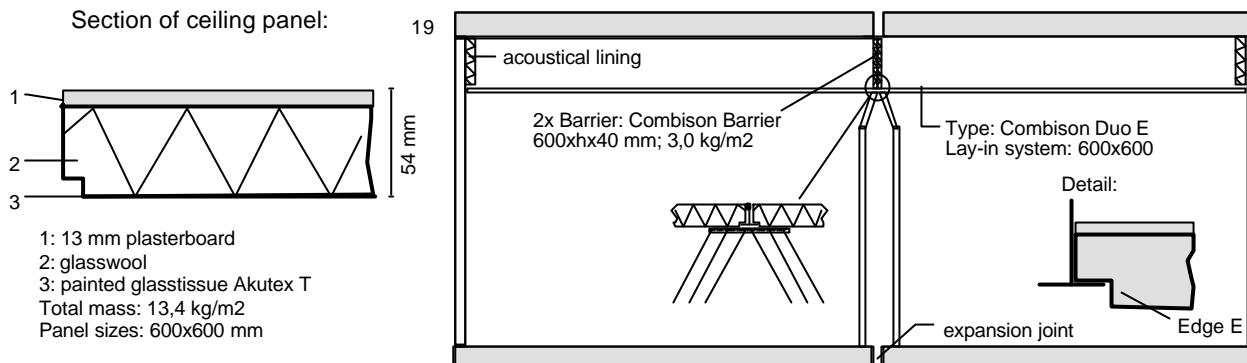

construction tested: #19; Combison Duo E, 600 x 600 x 54 + 2xbarrier



volume sending room: 59 m³

volume receiving room: 54 m³

reference area: 10 m²

surf. mass ceiling: 13,4 kg/m²

measured at: laboratory conditions

signal: broad-band noise

bandwidth: 1/3 octave

ISO 717-1:1996

$$D_{n,c,w}(C;C_{tr}) = 50(-1;-6) \text{ dB}$$

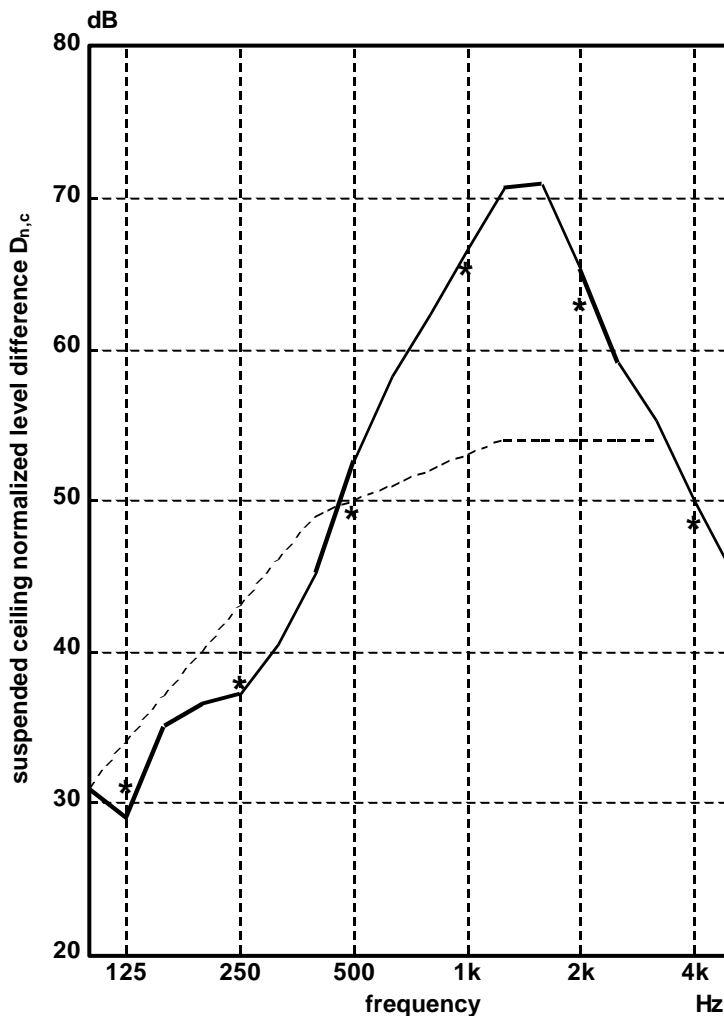

| | | | | | | |
|----------|------|------|------|------|------|---------|
| | 30.8 | 36.5 | 45.2 | 62.3 | 70.9 | 55.3 |
| 1/3 oct. | 29.0 | 37.2 | 52.6 | 66.7 | 65.4 | 50.0 dB |
| * | 35.0 | 40.5 | 58.2 | 70.6 | 59.2 | 45.2 |
| 1/1 oct. | 31.0 | 37.8 | 49.1 | 65.3 | 62.8 | 48.4 dB |

publication is permitted for the entire page only

Mook, 05-09-2002