

THE ROOM-TO-ROOM AIRBORNE SOUND INSULATION ACCORDING TO ISO 140-9:1985

principal: Ecophon (S)

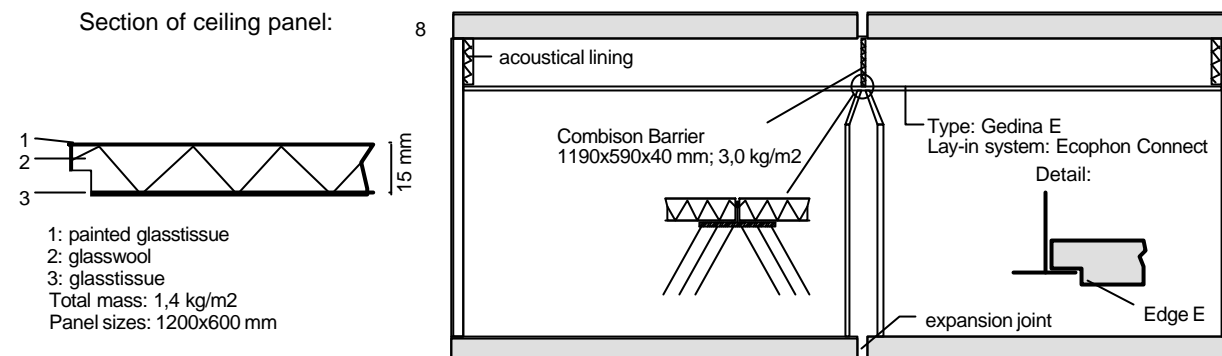

construction tested: #8: **Gedina E; 1200x600x15mm** with single "Combison Barrier"



volume sending room: 59 m³

volume receiving room: 54 m³

reference area: 10 m²

surf. mass ceiling: 1.4 kg/m²

measured at: laboratory conditions

signal: broad-band noise

bandwidth: 1/3 octave

ISO 717-1:1996

$$D_{n,c,w}(C;C_{tr}) = 32(-1;-4) \text{ dB}$$

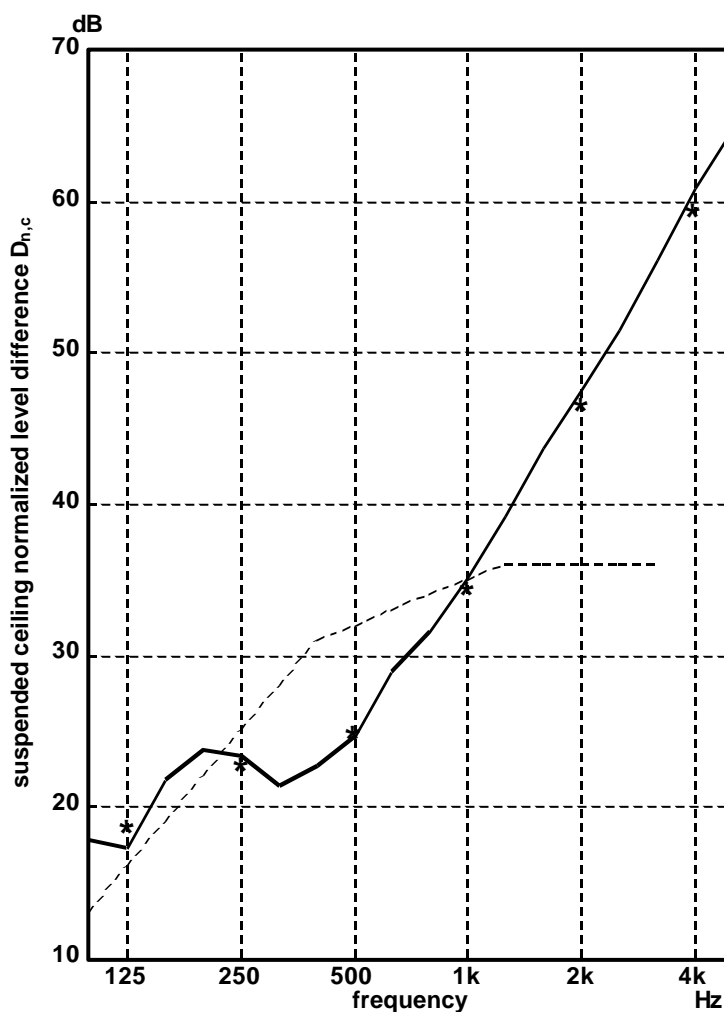

		125	250	500	1k	2k	4k
*	1/1 oct.	17.8	23.8	22.7	31.6	43.7	56.2
—	1/3 oct.	17.3	23.3	24.7	35.1	47.5	60.9
----	ref. curve (ISO 717)	21.8	21.3	28.9	39.2	51.5	64.9
	1/1 oct.	18.6	22.7	24.8	34.3	46.5	59.3 dB

publication is permitted for the entire page only

Mook, 29-04-2003